



advanced telemark bindings

Assembling Instruction for
7tm-tour **upgrade plate**
(for 2001/2/3 bindings)
E 005- 01

Caution:

You can use the boot adapting unit of a new **7tm tour**
with older release units from bindings of the 2001/2/3 series.

But the base plate first has to be upgraded.

Please replace the base plate as indicated below.

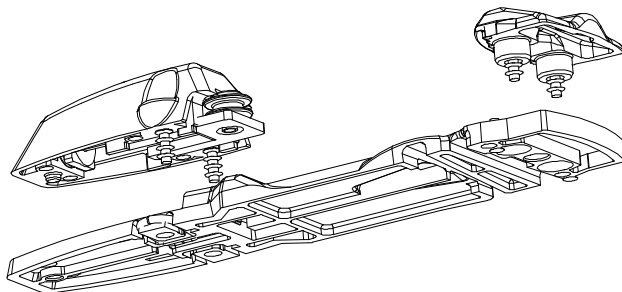

www.telemarking.de